

# Flat

Design by Ichiro Iwasaki.

## Reference

**5965.**

## Application

Table Lamps

## Installation type

Surface

## Description

The Flat table lamp offers multiple functionality; material and light are integrated in a single body. The Flat collection contains various planes of light that rise up to become self-illuminating supports.

## Diffuser

Polycarbonate diffuser

## Materials

Body: Steel  
Head: Aluminium  
Reflector: Aluminium

## Finish

 **5965-13** Grey L1 (NCS S 1000-N)

 **5965-47** Green L1 (NCS S 4005-G80Y)

## Sketch

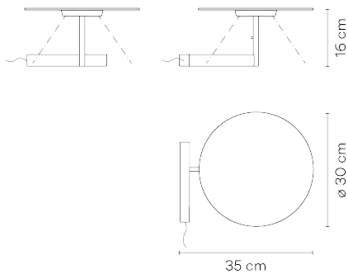

## Electrical characteristics

1 x LED PLATE 7W 400mA



Total 7.0 W



# VIBIA



**Light source:** 2700K CRI >90 1200 lm 171 lm/W

**Driver included:** CC - Constant Current 400 mA 100~240V 50/60Hz

**Electronic dimming** PUSH

## Technical characteristics

- 24V transformer at plug

## Physical characteristics

1 Box / 0.25 x 0.37 x 0.43 m. / Vol. 0.0383 m<sup>3</sup> /  
Gross weight 4.0 kg. / Net weight 3.1 kg.

## Installation and assembly

Please, see the installation manual

## Light distribution

### General lighting

Lamp for general lighting that equally distributes the light in all directions.



## Photometric data

Efficiency : 73.02 lm/W

Isolux : floor

Coordinate system : CG

Light position :

Total flux : 644.30 lm

X=0.00m Y=0.00m Z=2.50m

Maximum value : 259.03 cd

Light position : C=0.00 G=0.00

Symmetry on the planes : Double symmetrical

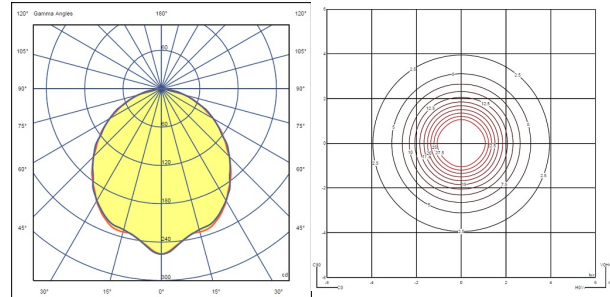

## Certificates



